

## **T.T.A. Table** **Mikal Harrsen** **2012**

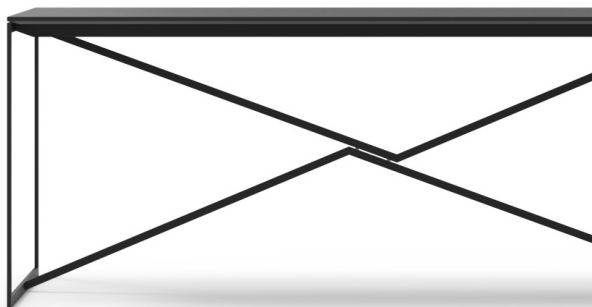

### **Tavolo**

#### **Materiali:**

BASE: profili in acciaio pieno verniciati a polvere color nero o bianco gofrato oppure verniciato a liquido color ottone.

PIANO IN CDF IMPIALLACCIATO, CDF PLACCATO: pannello in fibre di legno ad alta densità (CDF - certificato classe E1, CARB P2 / TSCA Title VI) nero opaco, oppure impiallacciato in rovere naturale o rovere affumicato, finito con vernice trasparente a poro aperto a base acqua o a base solvente, oppure placcato con superficie nanotecnologica Fenix NTM® "soft touch" color bianco Kos, grigio Londra o nero Ingo. Bordo nero a vista.

PIANO IN VETRO: vetro extrachiario, temperato, bordo filo lucido.  
PIANO IN CORIAN®: Corian® bianco semiopaco.

#### **Piano ovale**

PIANO OVALE IN LEGNO: pannello di particelle di legno (certificato classe E1, CARB P2 / TSCA Title VI) impiallacciato in rovere naturale o noce canaletto con bordo sagomato in massello, finito con vernice trasparente a poro aperto a base acqua o a base solvente.

PIANO OVALE IN LAMINATO: MDF (certificato classe E1, CARB P2 / TSCA Title VI) rivestito con laminato HPL bianco con bordo sagomato, finito con vernice color bianco.

PIANO OVALE IN FENIX NTM®: MDF (certificato classe E1, CARB P2 / TSCA Title VI) con superficie nanotecnologica Fenix NTM® colore nero opaco 'soft touch' con bordo sagomato, finito con vernice color nero.

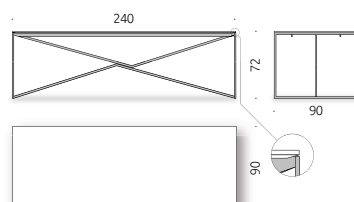
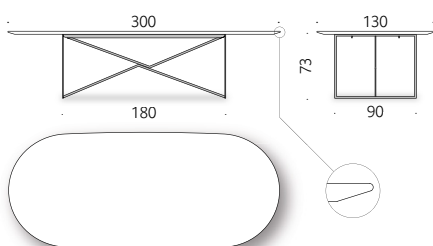
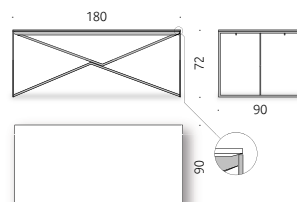
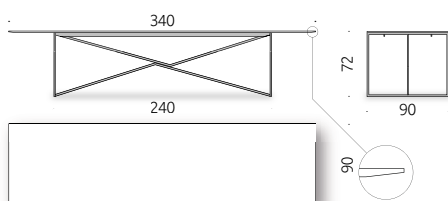
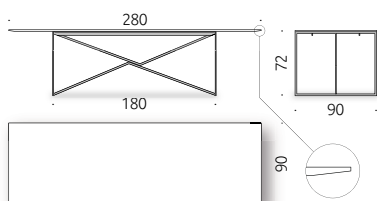

+info:  
<http://www.depadova.com/maustudio-materials.pdf>

# T.T.A. Table

## Mikal Harrsen

### 2012

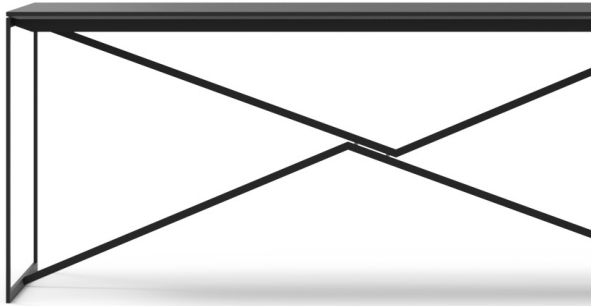

#### Table

##### Materials:

BASE: profiles in solid steel, powder-coated (embossed black or white) or liquid painted (brass).

TOP IN CDF VENEER, CDF COATED: matt black high-density wood fibres panels (CDF - class E1, CARB P2 /TSCA Title VI certified), veneered in natural or smoked oak, then finished with transparent open-pore water-based or solvent-based coating; or coated in "soft touch" Fenix NTM® (nanotechnology surface) in Kos white, Londra grey or Ingo black. Visible black edge.

TOP IN GLASS: extra clear glass, tempered, with polished edge.  
TOP IN CORIAN®: semi-matt white Corian®.

##### Oval top:

WOOD OVAL TOP: wood particle board panels (class E1, CARB P2 / TSCA Title VI certified) veneered in natural oak or Canaletto walnut, with shaped edge in solid wood, finished with transparent open-pore water-based or solvent-based coating.

LAMINATE OVAL TOP: MDF (class E1, CARB P2 / TSCA Title VI certified) coated with white HPL laminate, with shaped edge, finished with white paint.

OVAL TOP IN FENIX NTM®: MDF (class E1, CARB P2 / TSCA Title VI certified) with nanotechnological black matt "soft touch" FENIX NTM® surface, with shaped edge, finished with black paint.

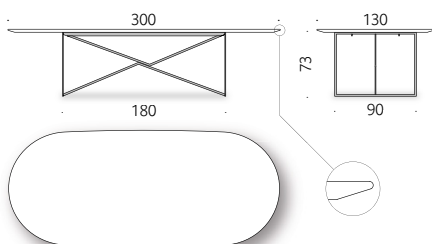
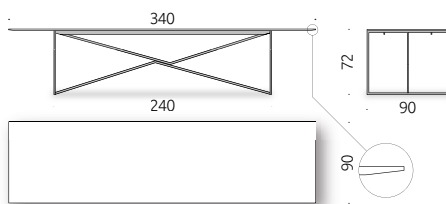
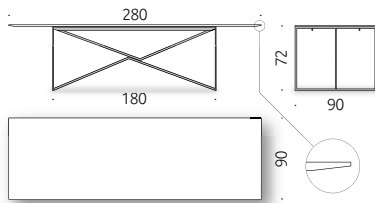

+info:  
<http://www.depadova.com/maustudio-materials.pdf>

